

# FOR LEASE



**Suite A**  
**2,025 SF**  
**\$35/SF + \$3.75/SF NNN**

[Take A Virtual Tour →](#)

## OVERVIEW

696 Somerset Terrace is a 1945 vintage Poncey-Highland building with three suites totaling 6,156 square feet.

## FEATURES

- » The available suite A is 2,025 square feet of street front retail space
- » Located between Cherry Blossom Salon and Liberty Tattoo, only a short walk to Ponce City Market and the Atlanta Beltline
- » The space has great character and charm with 11.5 foot high ceilings, exposed wood, exposed brick, and concrete floors
- » Plentiful natural light and open plan includes conference room and kitchen area

## Creative Office / Retail Space

696 Somerset Terrace, Atlanta, GA 30306



**FOR MORE INFORMATION, PLEASE CONTACT**

Brian Chambers | 404-371-4100 | [bchambers@oakrep.com](mailto:bchambers@oakrep.com)



# FOR LEASE



OAKHURST  
REALTY  
PARTNERS

## Creative Office Space

696 Somerset Terrace, Atlanta, GA 30306



**FOR MORE INFORMATION:** Brian Chambers: 404-371-4100 | [bchambers@oakrep.com](mailto:bchambers@oakrep.com)

Information contained herein has been obtained from sources deemed reliable but we cannot guarantee its accuracy. No liability is assumed for errors or omissions.



# FOR LEASE



## Creative Office Space

696 Somerset Terrace, Atlanta, GA 30306

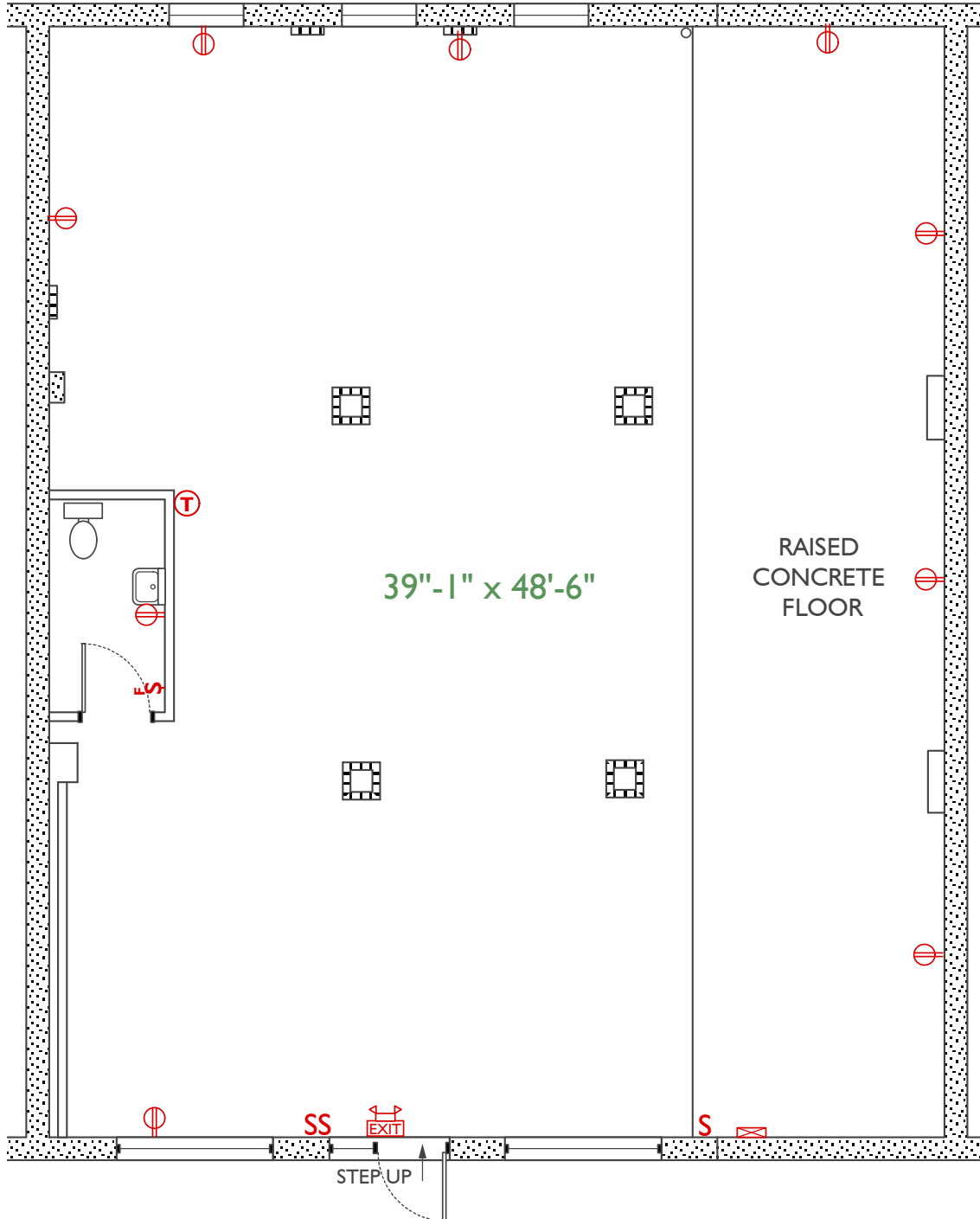

**FOR MORE INFORMATION:** Brian Chambers: 404-371-4100 | [bchambers@oakrep.com](mailto:bchambers@oakrep.com)

Information contained herein has been obtained from sources deemed reliable but we cannot guarantee its accuracy. No liability is assumed for errors or omissions.